

## Bead Colors

- Bubblegum x 25
- Salmon x 39
- Fuchsia x 41
- Tomato x 31
- Apricot x 39
- Orange x 29
- Yellow x 27

- Mint x 124
- Caribbean Sea x 493
- Parrot Green x 332
- Evergreen x 62
- Light Gray x 105
- Gray x 110
- Dark Gray x 19

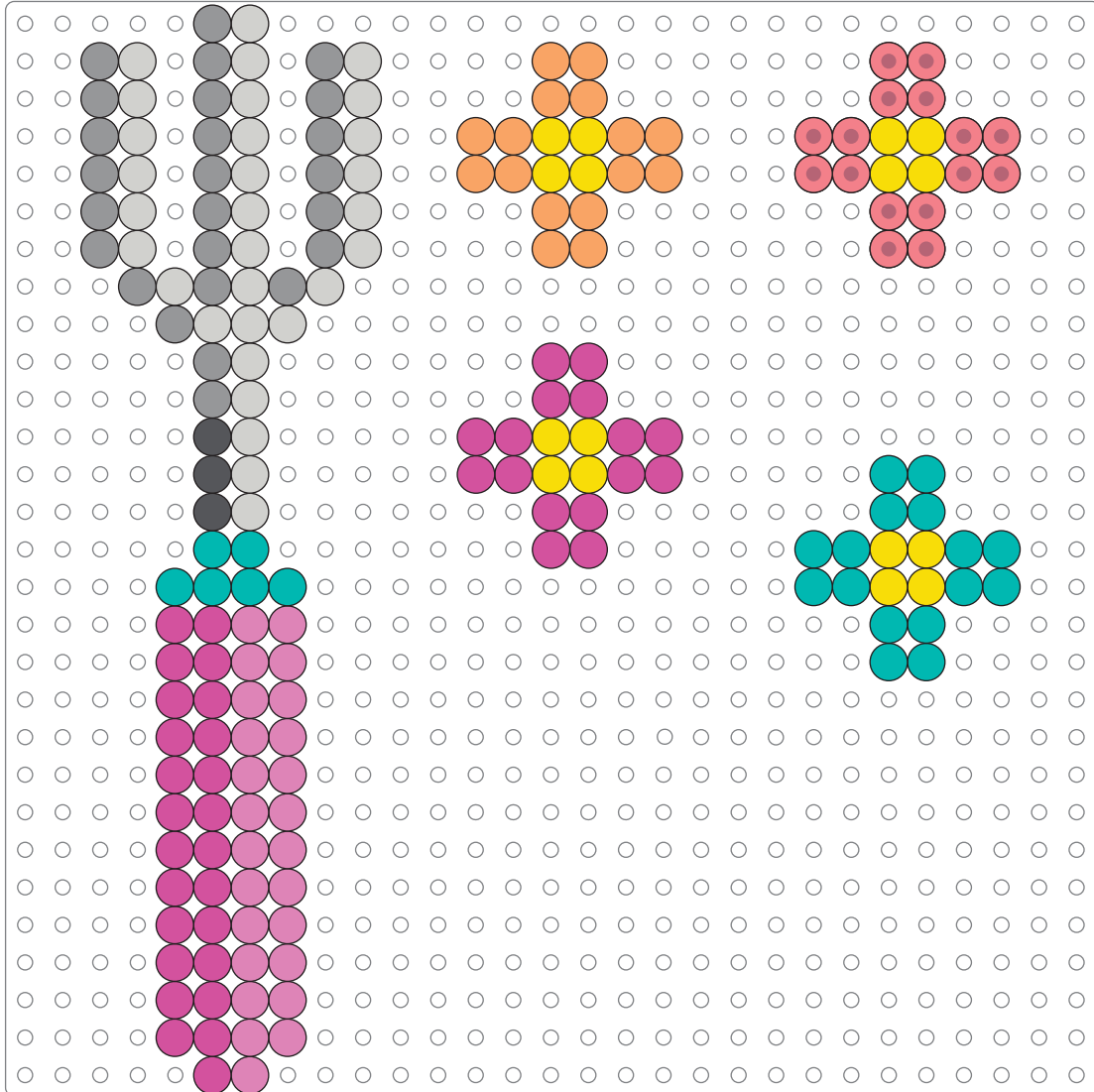

### Cording Hanger

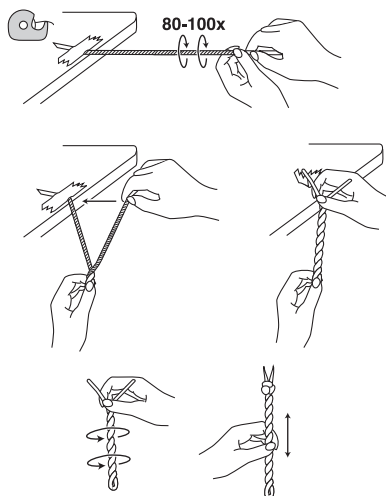

Tape one end of the thread to a table or counter. Twist the other end 80-100 times until the thread is tightly twisted. Grab the middle with one hand. Bring the ends together with your other hand. Release the middle and allow the thread to twist. Slide your fingers up and down the cording to even out the twists. Knot the ends together to prevent the cording from untwisting.

Fold the cording in half to make a loop of the desired size and knot the ends together. Glue the hanger to the back of the watering can.

Interlock the 4 pegboards together to form a large square.  
Align the pattern on this page with the pattern on page 4 to make the watering can.

